

DATA SHEET  
#SPS601

# STAINLESS STEEL “AUTO-SPRAY” NOZZLES

## Model

- Type NA-S: 60° Pattern “Auto-Spray” Narrow Angle Nozzle, Full Cone, High Velocity, Directional.
- Type MA-S: 90° Pattern “Auto-Spray” Medium Angle Nozzle, Full Cone, High Velocity, Directional.
- Type WA-S: 120° Pattern “Auto-Spray” Wide Angle Nozzle, Full Cone, High Velocity, Directional.
- Type LT-S: 40° Pattern “Auto-Spray” Long Throw Pattern, Full Cone, High Velocity, Directional.



## Approvals

- U.L. Listed, MEA Accepted, No. 192-98-E.

## To Specify

- Furnish and install “Automatic” Sprinkler Brand “Auto-Spray” Nozzle - Stainless Steel.

## Design Features

For design purposes, stainless steel nozzles may be considered identical to their brass counterparts. For dimensions, discharge patterns and discharge curves,

refer to data sheets for brass “AUTO-SPRAY” NOZZLES.

## Designation

“AUTO-SPRAY” NOZZLES in stainless steel carry the same basic numbers as the corresponding nozzles in brass - with one exception: Stainless steel nozzles are indicated by the suffix “S” following the nozzle number. For example, a No. 5NA is a narrow angle in brass. The same nozzle in stainless steel is a No. 5NA-S.

# “AUTO-SPRAY” NOZZLES - STAINLESS STEEL SUBMITTAL SHEET

## NARROW ANGLE NOZZLE

Physical Characteristics				
Nozzle Number	Dimensions			
	A	B	C	D
5 NA-S	1-7/8"	1-1/16"	3/4"	1-7/32"
7 NA-S	1-7/8"	1-1/16"	3/4"	1-7/32"
8 NA-S	1-7/8"	1-1/16"	3/4"	1-7/32"
10 NA-S	1-7/8"	1-1/16"	3/4"	1-7/32"
12 NA-S	1-7/8"	1-1/16"	3/4"	1-7/32"
14 NA-S	1-7/8"	1-1/16"	3/4"	1-7/32"

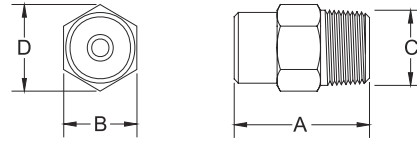

## WIDE ANGLE NOZZLE

Physical Characteristics				
Nozzle Number	Dimensions			
	A	B	C	D
10 WA-S	2-3/16"	1-5/16"	1"	1-17/32"
14 WA-S	2-3/16"	1-5/16"	1"	1-17/32"
18 WA-S	2-5/8"	1-11/16"	1-1/4"	1-15/16"
29 WA-S	2-5/8"	1-11/16"	1-1/4"	1-15/16"

## MEDIUM ANGLE NOZZLE

Physical Characteristics				
Nozzle Number	Dimensions			
	A	B	C	D
8 MA-S	2-1/16"	1-5/16"	1"	1-17/32"
13 MA-S	2-1/16"	1-5/16"	1"	1-17/32"
15 MA-S	2-1/16"	1-5/16"	1"	1-17/32"
19 MA-S	2-1/16"	1-5/16"	1"	1-17/32"
22 MA-S	2-1/16"	1-5/16"	1"	1-17/32"
26 MA-S	2-1/2"	1-11/16"	1-1/4"	1-15/16"
28 MA-S	2-1/2"	1-11/16"	1-1/4"	1-15/16"
38 MA-S	2-1/2"	1-11/16"	1-1/4"	1-15/16"

## LONG THROW ANGLE NOZZLE

Physical Characteristics				
Nozzle Number	Dimensions			
	A	B	C	D
15 LT-S	2-1/16"	1-5/16"	1"	1-17/32"
22 LT-S	2-1/16"	1-5/16"	1"	1-17/32"
31 LT-S	2-1/2"	1-11/16"	1-1/4"	1-15/16"

## Ordering Information and Design Data

Nozzle No.	Pipe Connection (NPT Male)	Discharge Angle	K Factor	Discharge At 30 psi (in gpm)	Nozzle Part No.	Submittal (Check One)
5NA-S	3/4"	60°	0.9	4.9	1415403	
7NA-S	3/4"	60°	1.2	6.6	1415404	
8NA-S	3/4"	60°	1.4	7.7	1415405	
10NA-S	3/4"	60°	1.8	9.9	1415406	
12NA-S	3/4"	60°	2.2	12.0	1415407	
14NA-S	3/4"	60°	2.6	14.2	1415408	
8MA-S	1"	90°	1.5	8.2	1415409	
13MA-S	1"	90°	2.3	12.6	1415410	
15MA-S	1"	90°	2.7	14.8	1415411	
19MA-S	1"	90°	3.4	18.6	1415412	
22MA-S	1"	90°	4.0	21.9	1415413	
26MA-S	1-1/4"	90°	4.8	26.3	1415414	
28MA-S	1-1/4"	90°	5.1	27.9	1415415	
38MA-S	1-1/4"	90°	7.0	38.3	1415416	
10WA-S	1"	120°	1.8	9.9	1415417	
14WA-S	1"	120°	2.6	14.2	1415418	
18WA-S	1-1/4"	120°	3.3	18.1	1415419	
29WA-S	1-1/4"	120°	5.3	29.0	1415420	
15LT-S	1"	40°	2.8	15.3	1415400	
22LT-S	1"	40°	4.1	22.5	1415401	
31LT-S	1-1/4"	40°	5.7	31.2	1415402	

This information is only a general guideline. The company reserves the right to change any portion of this information without notice. Terms and conditions of sale apply and are available on request.

06/02 Rev A Printed in USA SPS601.QXD